



**2010 European Gold Forum**  
**April 14, 2010**

Presented by:  
**Edward C. Dowling, Jr.**  
**President & CEO**





# Cautionary Statements

## FORWARD LOOKING STATEMENTS

Except for statements of historical fact relating to Anatolia, certain statements contained in this presentation constitute forward-looking information, future oriented financial information, or financial outlooks (collectively "forward-looking information") within the meaning of Canadian securities laws. Forward-looking information may relate to this presentation and other matters identified in Anatolia's public filings, Anatolia's future outlook and anticipated events or results and, in some cases, can be identified by terminology such as "may", "will", "could", "should", "expect", "plan", "anticipate", "believe", "intend", "estimate", "projects", "predict", "potential", "targeted", "possible", "continue", "objective" or other similar expressions concerning matters that are not historical facts and include, but are not limited in any manner to, those with respect to commodity prices, mineral resources, mineral reserves, realization of mineral reserves, existence or realization of mineral resource estimates, results of exploration activities, the timing and amount of future production, the timing of construction of the proposed mine and process facilities, capital and operating expenditures, cash flows, the timing of receipt of permits, rights and authorizations, communications with local stakeholders and community relations, status of negotiations of joint ventures, availability of financing and any and all other timing, development, operational, financial, economic, legal, regulatory and political factors that may influence future events or conditions. Such forward-looking statements are based on a number of material factors and assumptions, including, but not limited in any manner, those disclosed in any other of Anatolia's public filings, and include the ultimate determination of mineral reserves, availability and final receipt of required approvals, licenses and permits, sufficient working capital to develop and operate the proposed mine, access to adequate services and supplies, economic conditions, commodity prices, foreign currency exchange rates, interest rates, access to capital and debt markets and associated cost of funds, availability of a qualified work force, lack of social opposition and legal challenges, and the ultimate ability to mine, process and sell mineral products on economically favorable terms. While Anatolia considers these assumptions to be reasonable based on information currently available to it, they may prove to be incorrect. Actual results may vary from such forward-looking information for a variety of reasons, including but not limited to risks and uncertainties disclosed in other Anatolia filings at [www.sedar.com](http://www.sedar.com). Forward-looking statements are based upon management's beliefs, estimate and opinions on the date the statements are made and, other than as required by law, Anatolia does not intend, and undertakes no obligation to update any forward-looking information to reflect, among other things, new information or future events.

This presentation does not represent a solicitation or offer to sell securities.



# Profile – TSX: ANO & ANO.DB

- 20 Day VWAP Cdn \$4.46
- 52-Week Low/High Cdn \$2.01 – 4.72
- Market Cap \$590 million
- Average Daily Volume 600,000
- Shares
  - Issued & outstanding 138.1 million
  - Fully diluted 157.3 million
- Convertible Debenture: Cdn\$100 million
- Cash Position (December 31, 09): \$83 million
- Key Shareholders/Partners: Pala Invest  
Çalık Mining
- Experienced Management Team
- Strong Board of Directors

- Current Analyst Coverage
  - BMO Capital Markets
  - Dundee
  - Paradigm Capital
  - Raymond James
  - RBC Capital Market
  - Wellington West
  - Haywood (under review due to departure of analyst)
  - National Bank (under review due to departure of analyst)





# Overview

- Developing Çöpler Gold Mine - First Production This Year
- Exciting Gold Growth Potential - Oxides & Sulfides
- Significant Exploration Pipeline
- Well Positioned for Value Creation

*Primary Crusher Excavation Early November '09*



*Primary Crusher Excavation (23 meters) End of December '09*





# Çöpler Gold Mine

- First Production This Year
- Low Cost 1<sup>st</sup> Quartile Gold Mine
- Fully Permitted and Funded
- Oxide Production & Economics (100%)
  - 175,000 avg ozs/year Au and 150,000 avg ozs/year Ag
  - Initial oxide mine life 8 years
  - LOM cash costs - \$260 per ounce gold
  - CapEx ~\$190 Million
  - Annual After Tax Cash Flow – LOM  
@ \$900 Au \$90 million
  - Additional tax incentive credits



# Construction Momentum



*Stripping Benches – end of March '10*



*Primary Crusher – end of March '10*



*Secondary Crushing Plant & Bin Foundations – end of March '10*



*Plant Site – end of March '10*



# Construction Momentum



*Rock-Fill and Rough Grading of Leach Pad – end of March '10*



*Under-Liner Placement for Geosynthetic Clay Liner – end of March '10*



*Portable Crusher – end of March '10*



*Over-Liner Production – Portable Crushing Plant – end of March '10*

# Construction Momentum



*Çiftay (Mining Contractor) Camp Site*



*Çiftay (Mining Contractor) Camp Site*



*Çiftay (Mining Contractor) Truck Shop*



*Labs – Assay, Met, Cyanide, Sample Prep*



# Construction Momentum



*Batch Plant*



*Heap Leach Stacker Conveyors – End of February '10*



*Pond Area Rock Fill Complete – March '10*



*General Overview – February '10*



# Çöpler Organic Growth Potential

- Gold Reserves & Resources (100%)
  - Global Resources – 6+ million ozs all categories
  - Oxide reserves: 2.2mm ozs @ 1.65 gpt
  - Oxide resources: 0.6 mm ozs @ 0.77 gpt
  - Sulfide resources: 3.2 mm ozs @ 1.73 gpt
- Global Resources Update - 2010
- Sulfide Pre-Feasibility Study - Q4/10

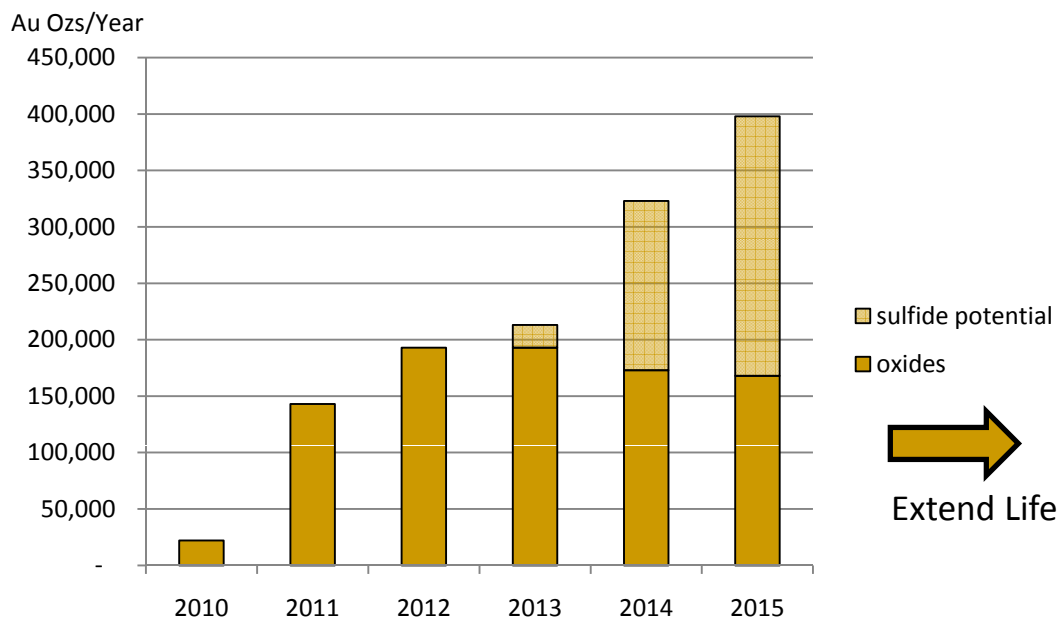



# Çöpler Organic Growth - Sulfides

Hole #	Meters	Au (gpt)	Ag (gpt)	Zone
CDD-201	78.5	5.49	3.14	Manganese
CDD-202	62.0	9.75	21.98	Manganese
CDD-206	37.0	2.65	10.7	Main
CDD-211	51.0	2.51	5.0	Main
CDD-228	21.0	11.28	10.6	Main

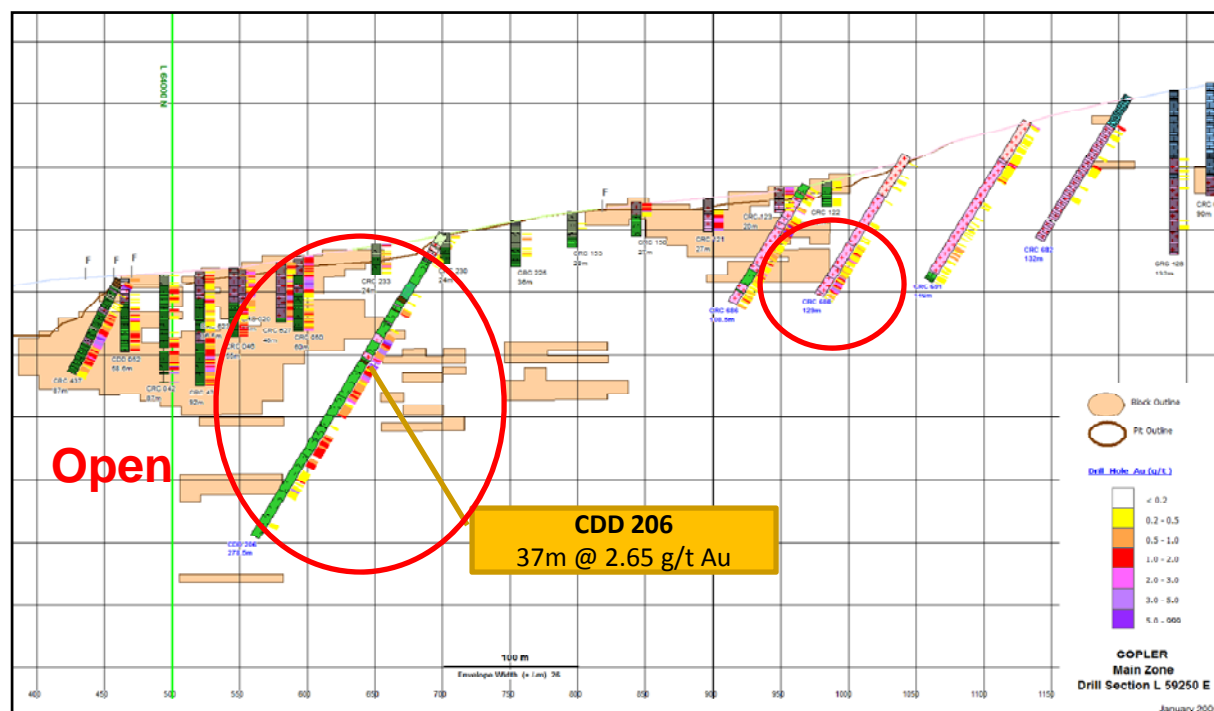



# Organic Growth - Elsewhere

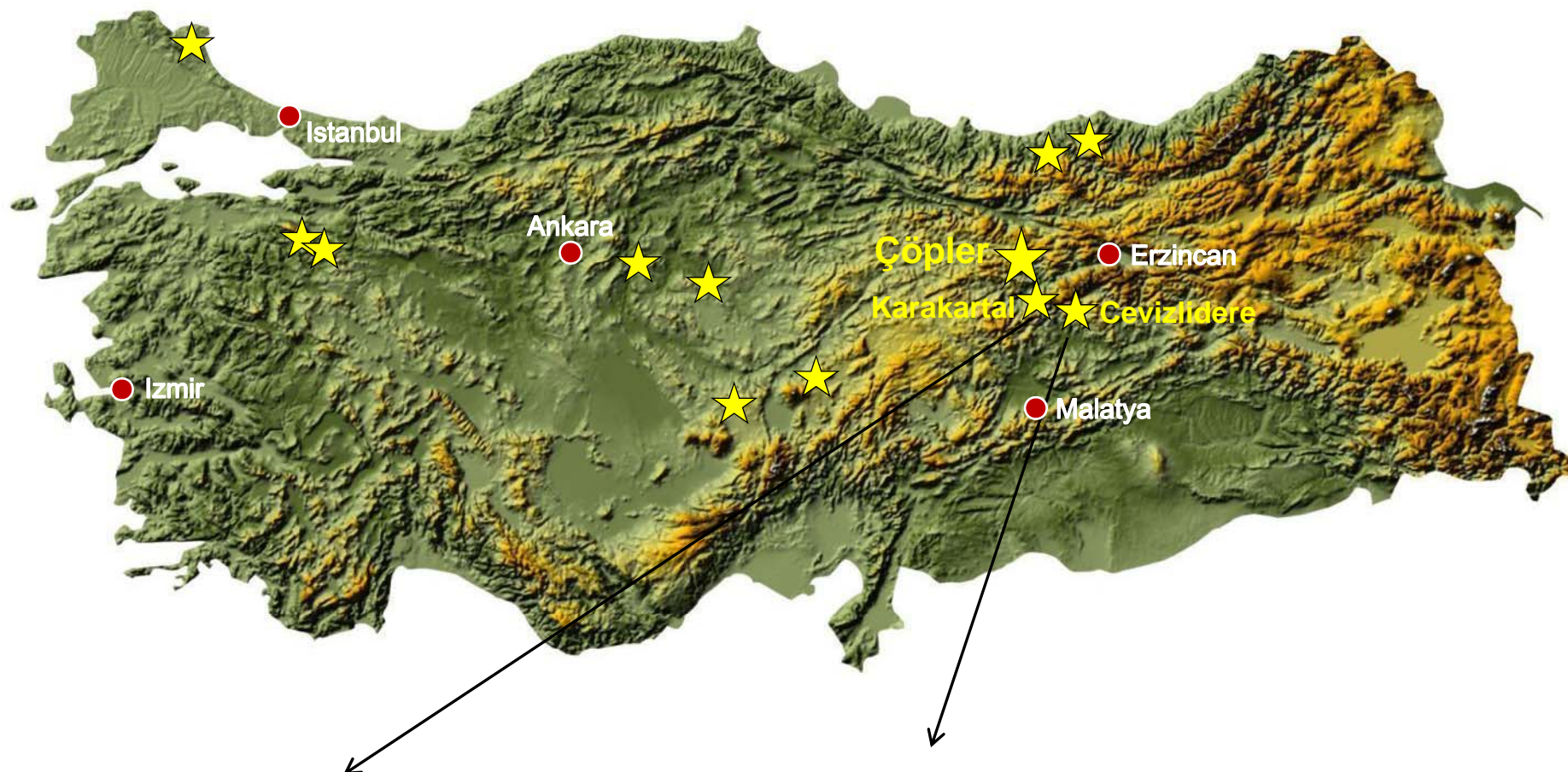

## Karakartal

Indicated & Inferred Resources of 70 million tonnes @ 0.41% CuEq

## Cevizlidere

Inferred Resource 446 million tonnes @ 0.38% Cu, 0.11 Au g/t, 47.76 Mo ppm



# Sources and Uses

## Sources

Cash December 31, 2009	\$ 83,000,000.00	
Other	\$ 16,000,000.00	
Total Sources		\$ 99,000,000

## Uses

Çöpler Phase 1 Remaining	\$ (66,000,000.00)	
Çöpler WIP Inventory	\$ (9,000,000.00)	
Debenture Interest	\$ (5,000,000.00)	
Exploration & Other Development	\$ (4,000,000.00)	
Other	\$ (5,000,000.00)	
Total Uses		\$ (89,000,000)

## Reserves

\$ 10,000,000



Drilling at Çöpler





# Upcoming Events

- Construction Updates
  - Key Milestones
  - Quarterly
- First Gold Pour
- Ramp-Up Progress
- Çöpler Economics Update
- Cevizlidere
  - Formation of JV
  - 2010 Program
- Karakartal
- Global Resource Update
- Çöpler Sulfide Pre-Feasibility Study

*General Site Overview - December '09*



*General Site Overview – March '10*







# Positioned for Success

- Momentum for Production Q4 2010
- New Low Cost Gold Mine
- Generates High Cash Flow
- Çöpler Organic Growth Potential - Oxides and Sulfides
- Exploration Growth Potential Elsewhere
- Well Positioned for Future Growth

*Laydown Area*



# Questions & Answers





# Çöpler Reserves & Resources

As Reported: NI 43-101 November 2008

As Reported: At 40:101 November 2000							
	Tonnes	Gold Gpt	Silver Gpt	Gold Contained	Silver Contained	Reserves	
						Gold Recovered	Silver Recovered
OXIDE RESERVES & RESOURCES							
<i>Oxide Reserves</i>							
Proven Reserves	32,792,000	1.69	4.08	1,781,486	4,301,558		
Probable Reserves	8,038,000	1.50	2.44	387,585	630,573		
	40,830,000	1.65	3.76	2,169,071	4,932,131	1,300,000	1,000,000
<i>Oxide Resources</i>							
Measured	15,908,000	0.76	1.35	387,240	690,474		
Indicated	8,725,000	0.78	1.25	219,278	350,649		
Inferred	1,448,000	0.85	0.77	39,418	39,572		
	26,081,000	0.77	1.29	645,936	1,080,695		
<i>Sulfide Resources</i>							
Measured	24,805,000	1.70	6.48	1,359,179	5,167,874		
Indicated	31,458,000	1.74	4.76	1,760,300	4,814,329		
Inferred	1,840,000	1.80	3.40	106,468	201,138		
	58,103,000	1.73	5.45	3,225,947	10,183,341		
Total Reserves & Resources	125,014,000	1.50	4.03	6,040,954	16,196,167		





# Çöpler Cash Costs Breakdown

	43-101
	Parameters (Nov '08)
<b>Mining Cost / Ore Tonne</b>	<b>\$ 4.94</b>
<b>Processing Cost / Ore Tonne</b>	
Crushing	\$ 0.79
Process	\$ 2.80
G&A (and Gen'l Plant)	\$ 0.84
Mining tax	\$ 0.07
<b>Total Processing Cost</b>	<b>\$ 4.50</b>
<b>Total Cost Per Ore Tonne</b>	<b>\$ 9.44</b>
 <b>Cash operating cost/oz</b>	 <b>\$ 260</b>



# Çöpler Oxides – Phase 1

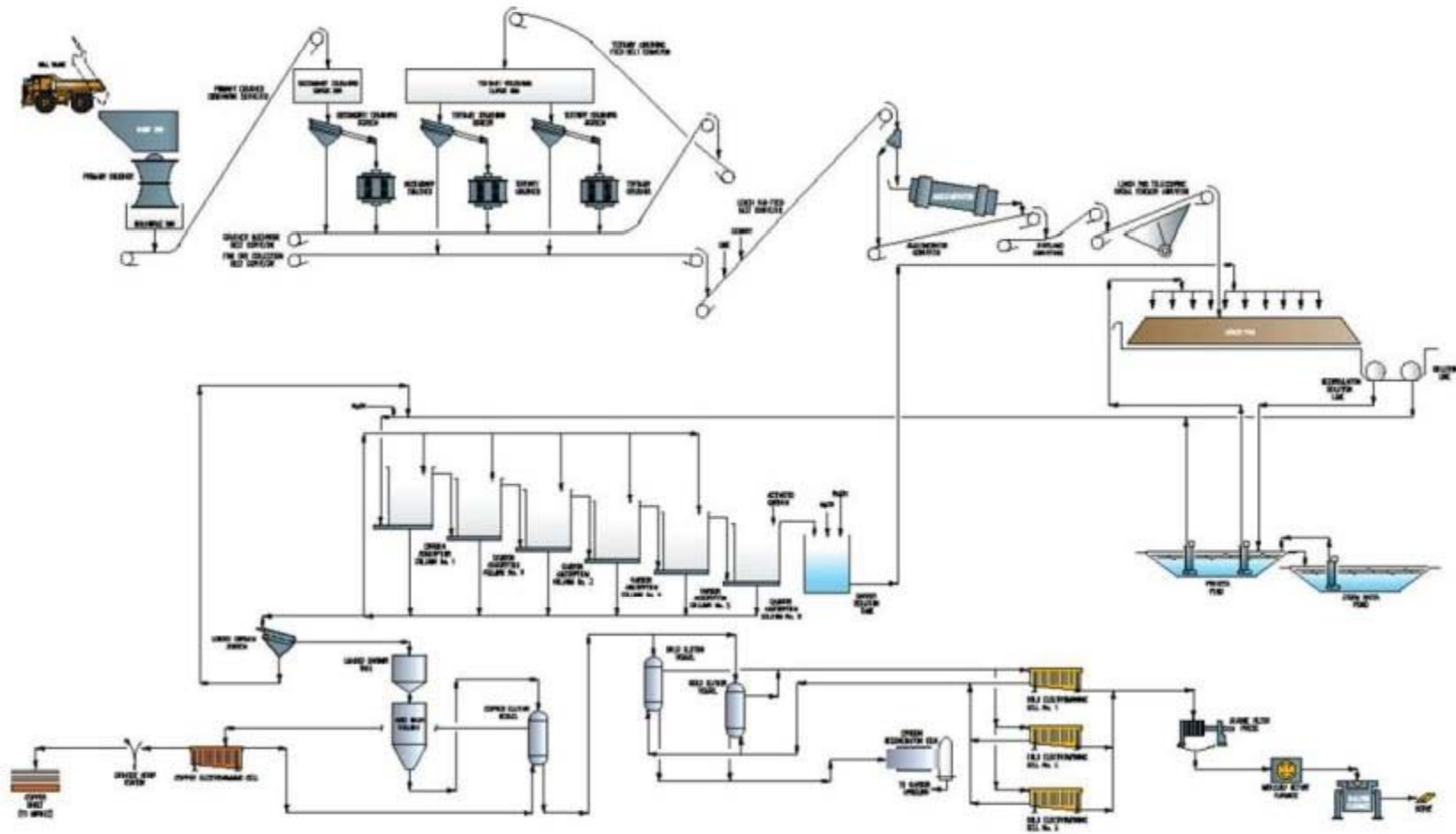

# SART Process Flow Sheet

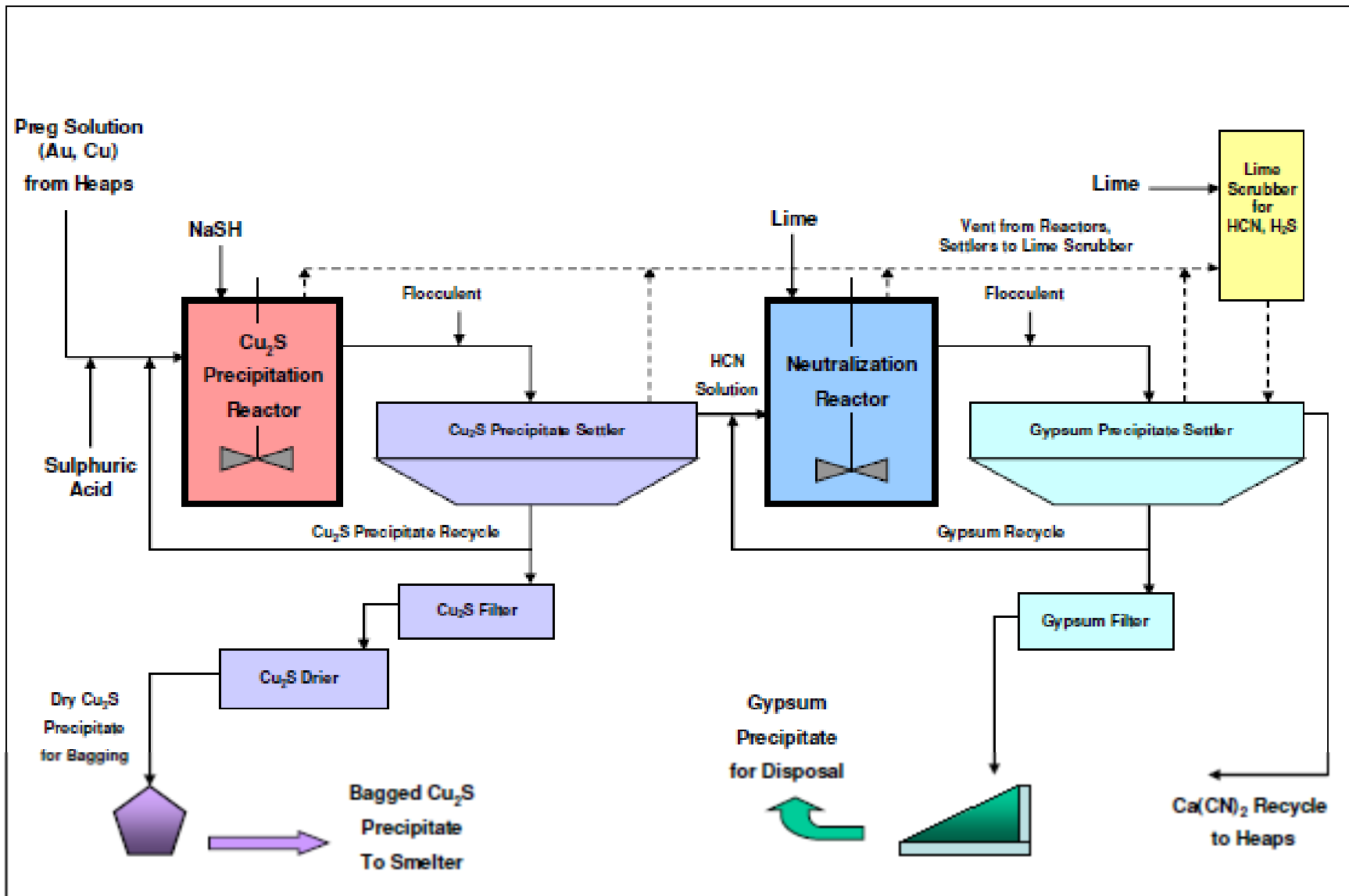



# Çöpler Facility Layout

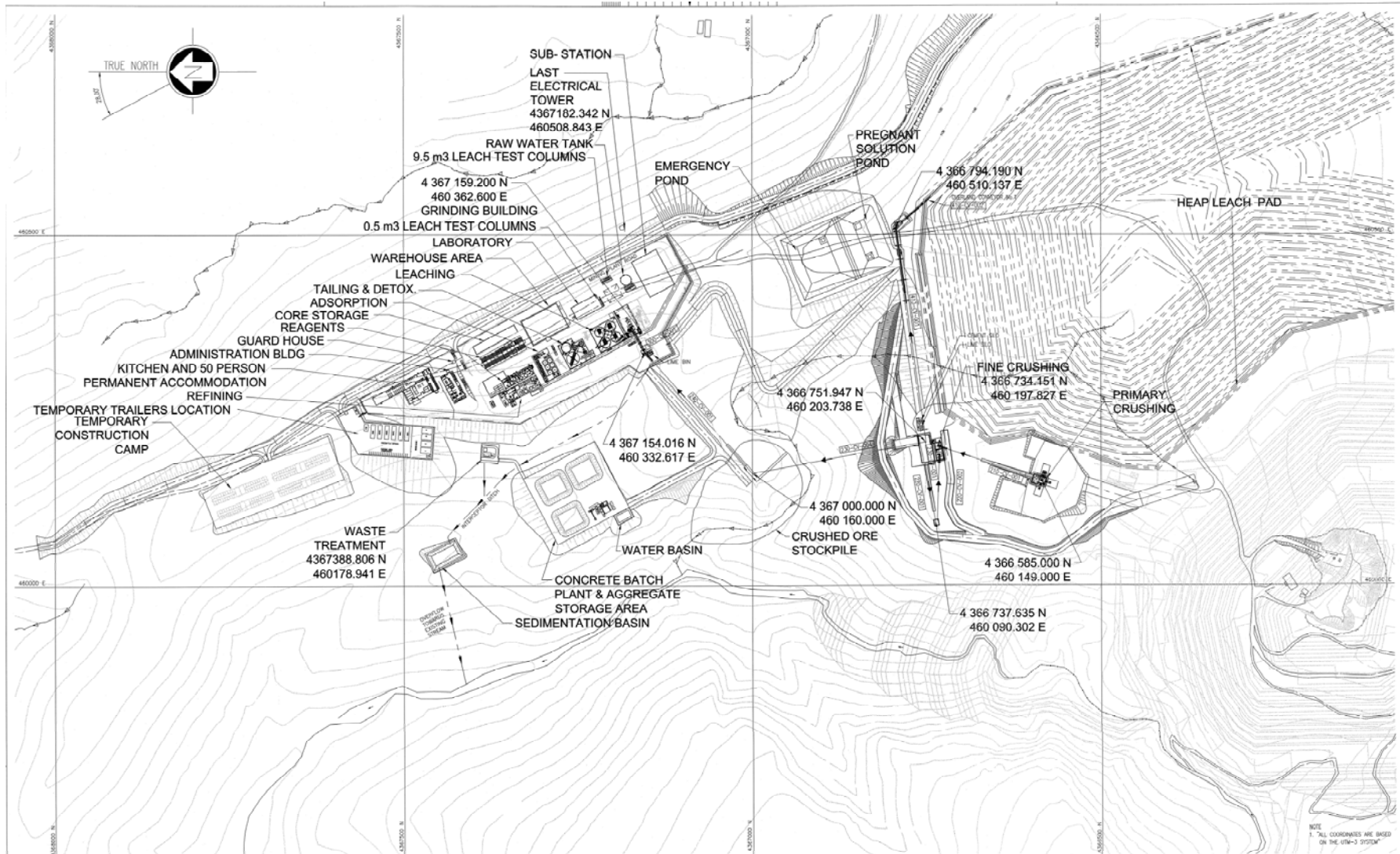

# ÇÖPLER Drill Plan & Mineralization

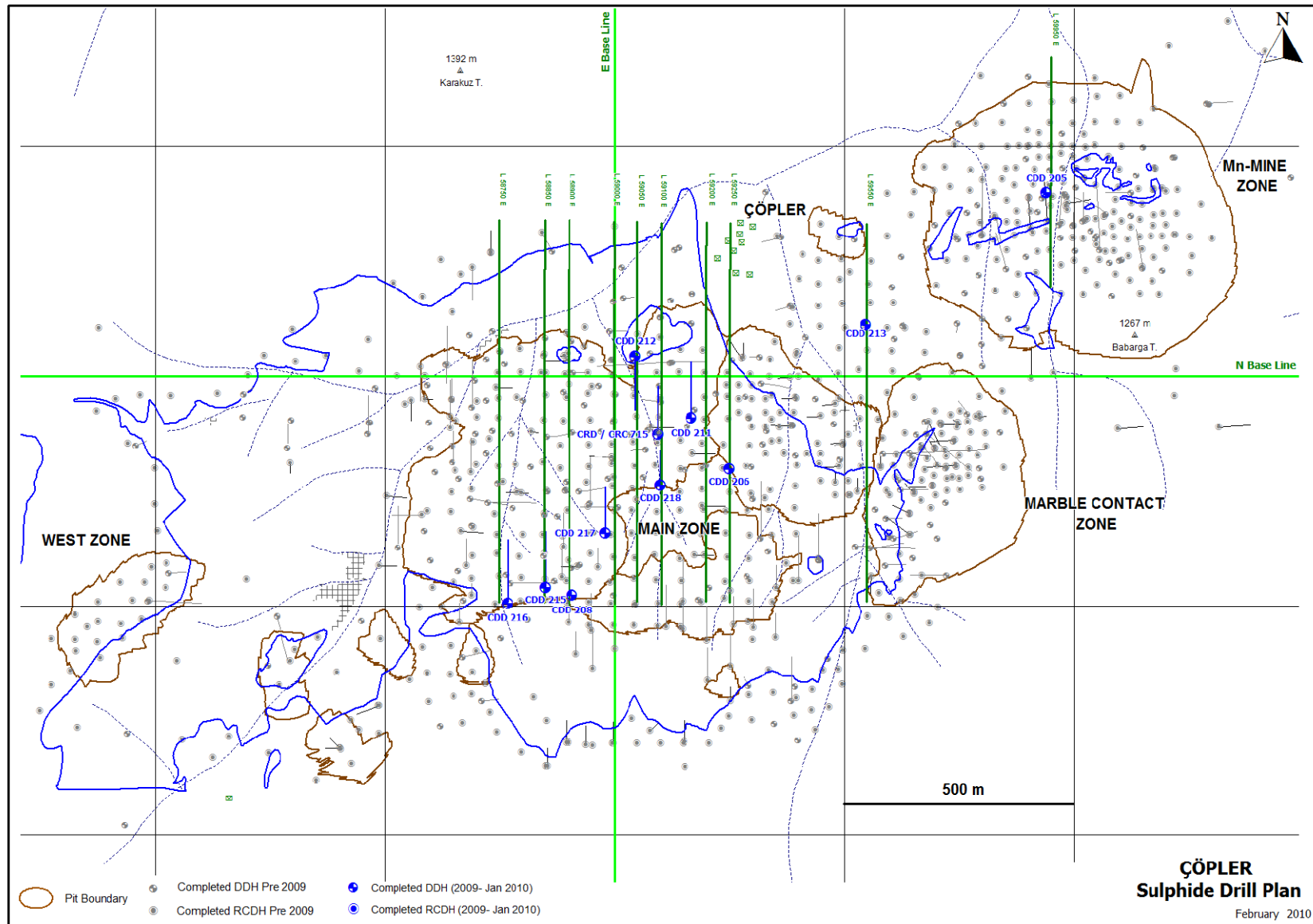

# ÇÖPLER Mn-Mine Pit Drill Section L 63900N

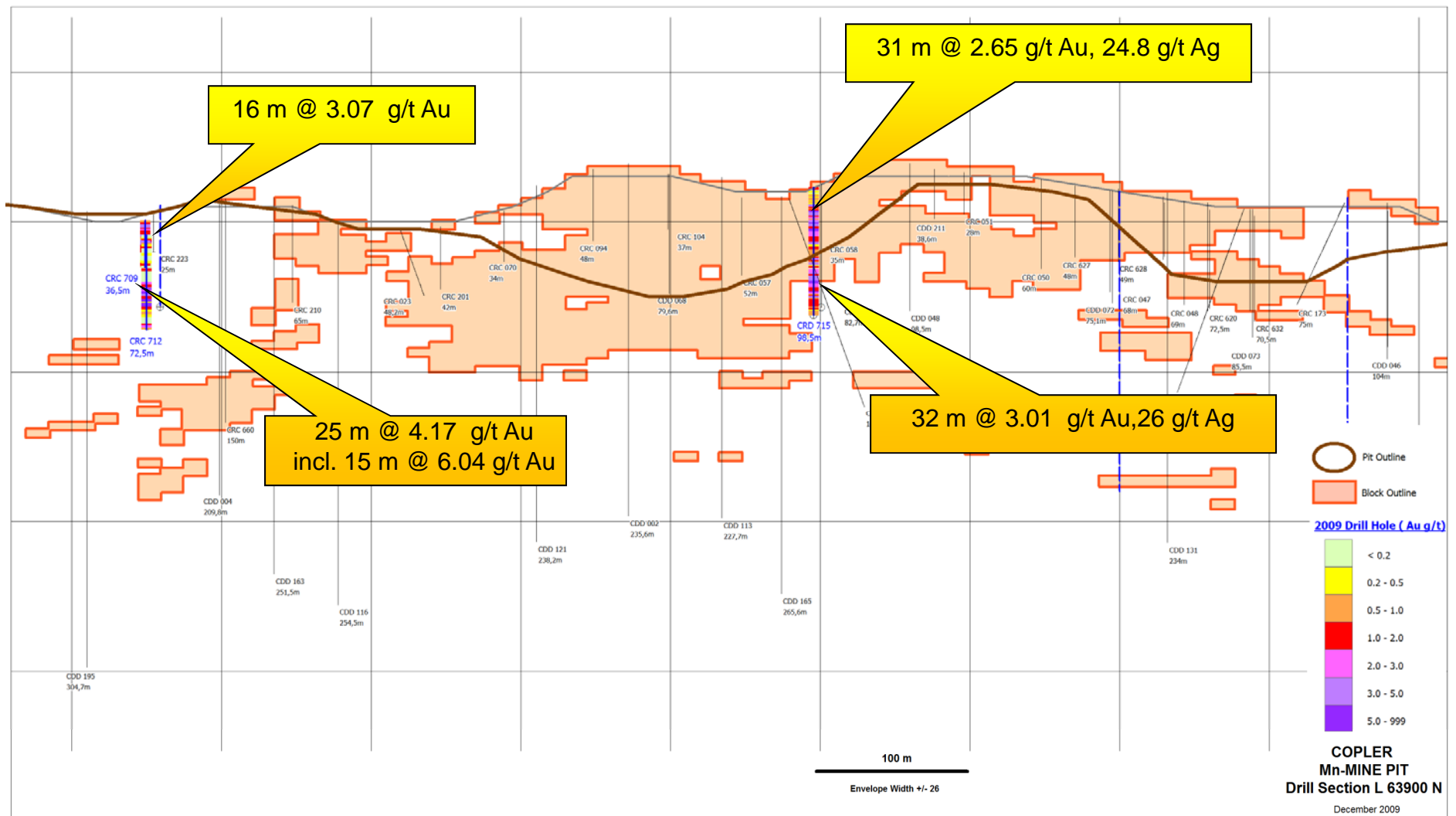



# ÇÖPLER Mn-Mine Pit Drill Section L 60100 E

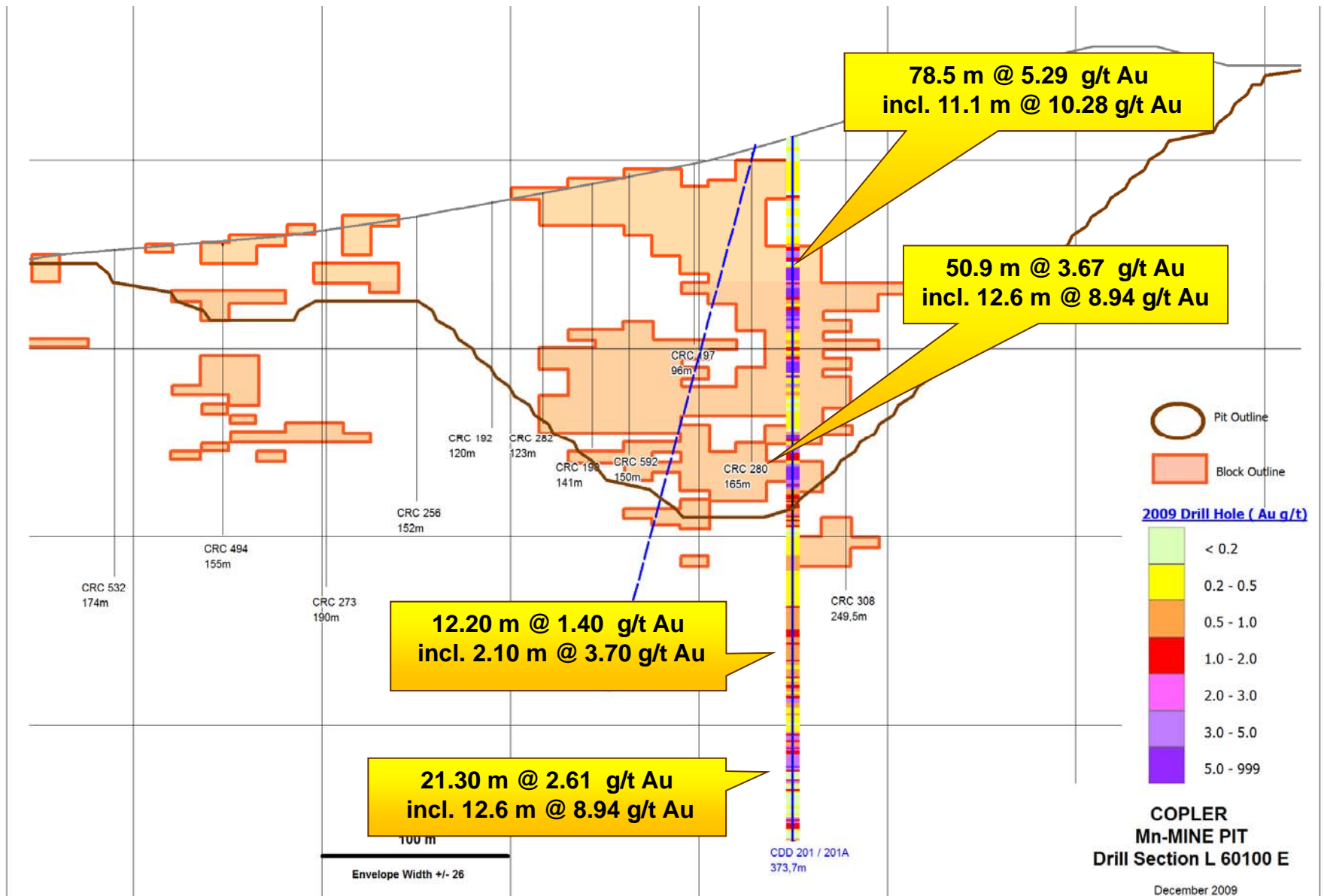

# ÇÖPLER Mn-Mine Pit Drill Section L 59950 E

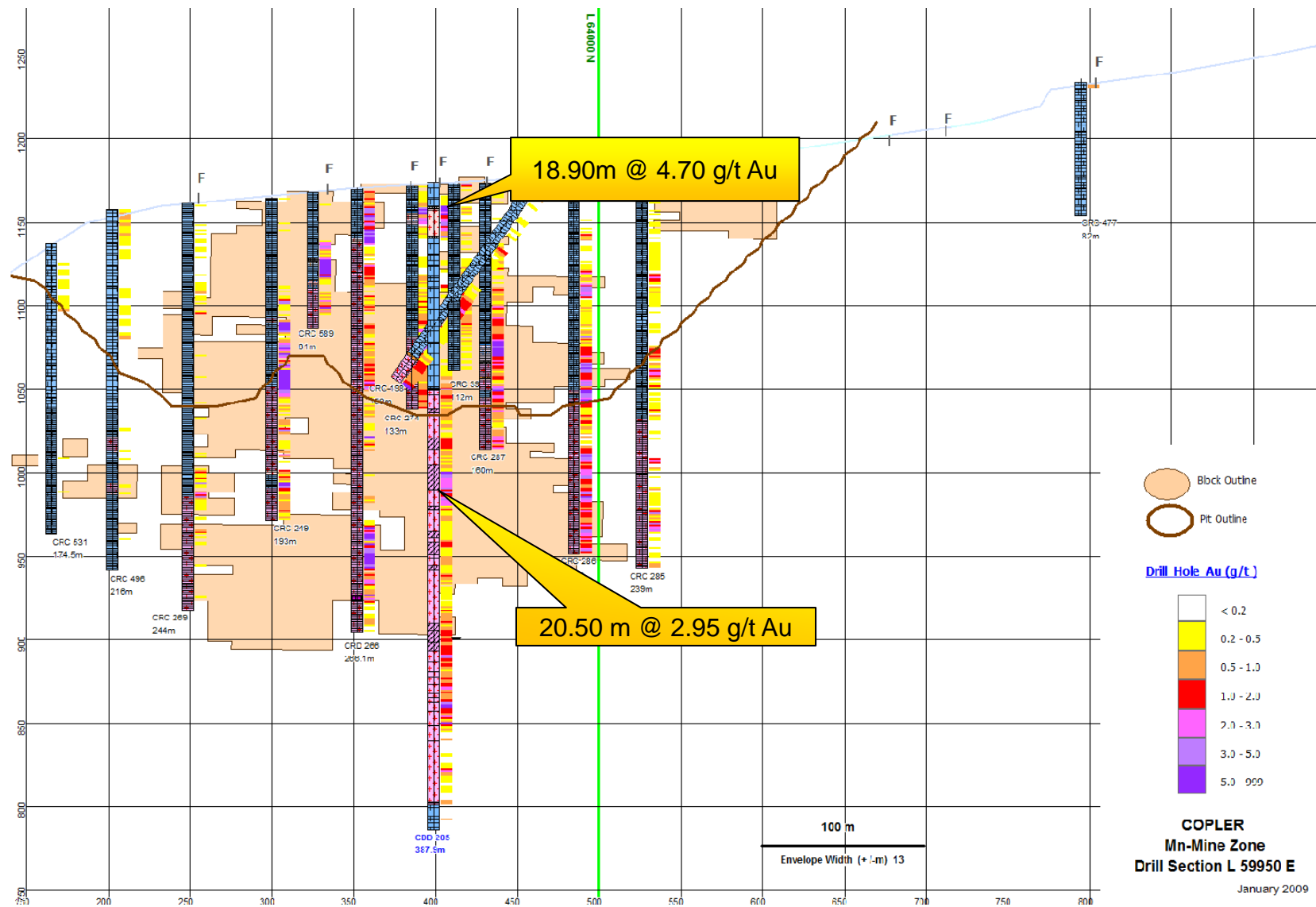





# ÇÖPLER Main Zone - Drill Section L 58650 E

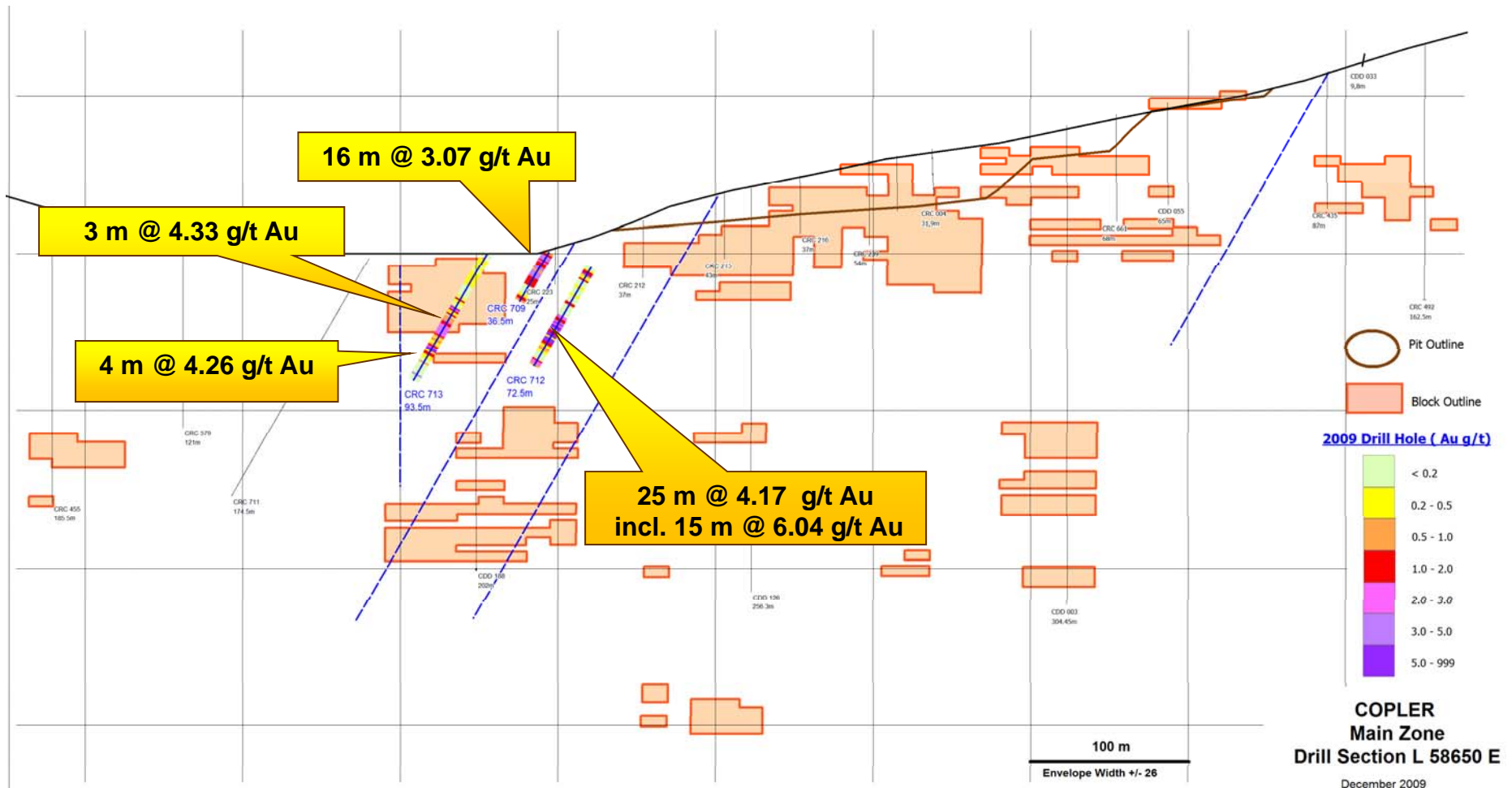

# Proposed Sulfide Flow Chart

Block Diagram – Sulfide Treatment

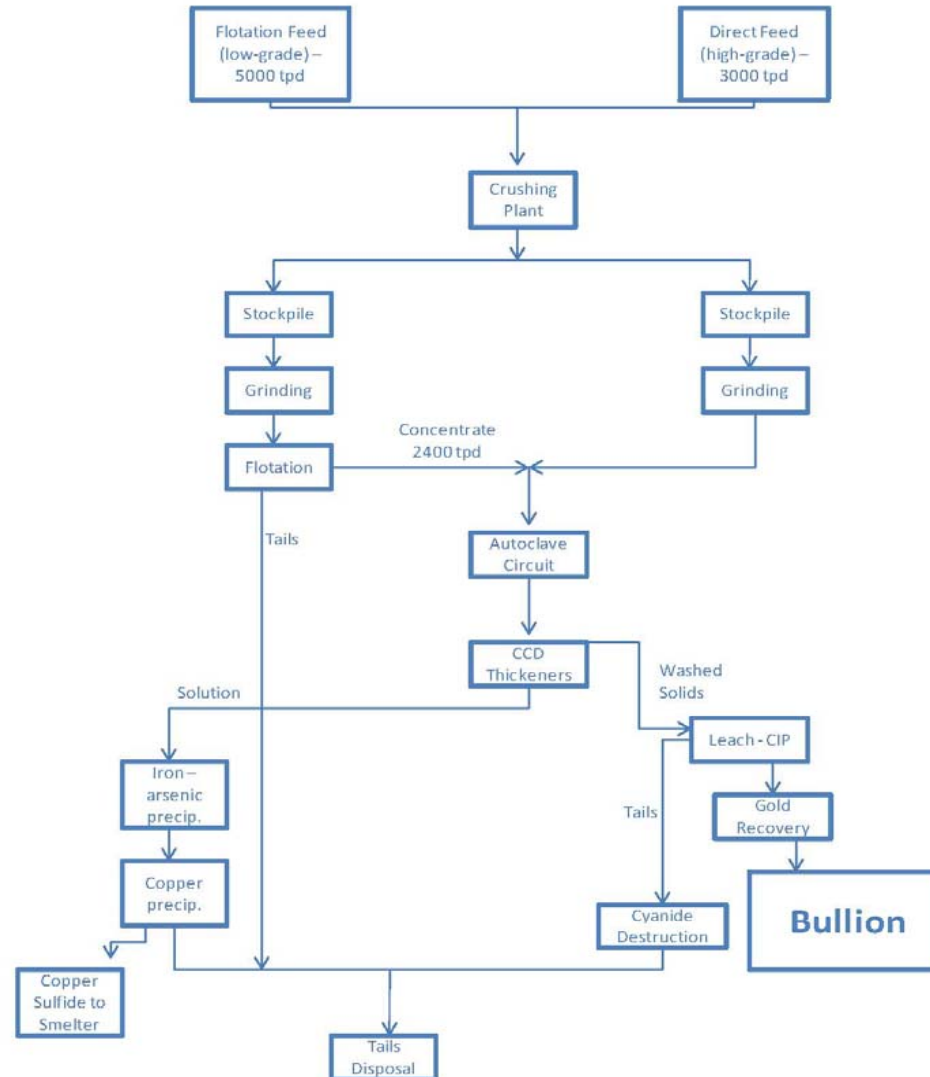



# Çalık: Terms & Structure

**The strategic relationship with Çalık Mining will advance Anatolia's interests and future development**

<b>Initial Strategic Investment</b>	<ul style="list-style-type: none"><li>Çalık Mining subscribed to a 5% interest in the Çöpler Gold Project with payments over the next 12-months totalling US\$12.6 million</li></ul>
<b>Option to Purchase an Additional 15% Stake</b>	<ul style="list-style-type: none"><li>Anatolia has granted Çalık Mining an option, expiring December 31, 2011, to acquire up to an additional 15% interest in Çöpler for an additional US\$37.8 million</li></ul>
<b>Strategic Relationship for Future Development</b>	<ul style="list-style-type: none"><li>The strategic relationship allows for and supports cooperation and cross investment to jointly explore and develop other mineral properties in Turkey on a 50/50 basis</li></ul>
<b>Ahmet Çalık to join the Board of Directors</b>	<ul style="list-style-type: none"><li>As part of the strategic relationship, Mr. Ahmet Çalık will join the Board of Directors of Anatolia Minerals</li></ul>
<b>Other Key Terms</b>	<ul style="list-style-type: none"><li>Çalık assumes share of project debt</li><li>The proceeds from the subscription and exercise of the option will accrue to the benefit of Anatolia</li></ul>

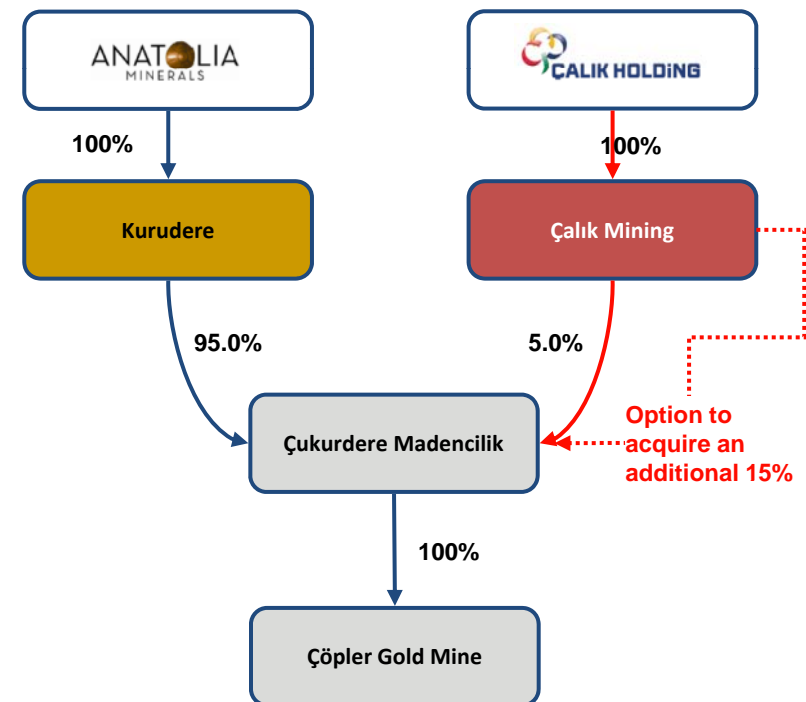





# Key Çalık Holding Divisions



## Energy

- Çalık Energy is the Group's energy subsidiary founded in 1998
- Active in three main business lines:
  - power systems
  - oil & natural gas
  - pipeline & refinery
- EPC contractor and investor of power plants in Central Asia and Turkey

## Finance

- Aktif Bank is Group's investment bank providing corporate banking services in Turkey
- BKT, wholly owned by the Group, 2nd largest bank in Albania with \$1.2 billion in assets, 52 branches in Albania and 10 in Kosovo

## Textile

- Leading manufacturer of high-quality denim cloth, which it supplies to customers around the world
- Engaged in a variety of textile manufacturing activities in Turkey, Turkmenistan and Egypt
- Offices in US, Italy, S. Korea, Belgium
- Accounts for 30% of Turkish denim export

## Media

- Second largest media enterprise in Turkey with 20% share in the advertising market
- Media assets include:
  - Newspapers and Magazines
  - Visual Media
  - Publishing and Distribution
  - Production and News Agency
  - Digital Media and Mobile Services

## Construction

- Construction and contracting activities
- International contractor with projects ranging from textile factories to heavy-industry facilities, from housing to highways and from schools to museums
- Currently operates several projects in Central Asia, Arabian Peninsula and Africa

## Telecommunication

- Fixed and mobile services in Albania
- Primary units: Albtelecom & Eagle Mobile
  - 295,000 fixed line subscribers
  - 30,000 ADSL clients
  - 510,000 mobile clients
- Albtelecom incumbent, Eagle 3rd GSM operator in the country

The strategic partnership will allow Çalık Holding to expand its established global operations to include mining and exploration